

State of S^c Carolina Pursuant to a warrant from John Thomas Esq. Comr. of locations 96 District & Saluda Anthony Golden's land I have admeasured & laid out unto Charles Perrel a tract of 126 acres of land in 96 District, on the waters of Middle Creek of Saluda River, bounded by lines 126 & 127 of Anthony Golden, & by lines running N. 88. 4/4 W on William Lowrey; & on lines 126. and 127. of John Williams and on a line supposed to be John Brysons 126. & by a line 126. on Charles Compton and hath such shape and marks as the above Plat represents, Survey 15th Juny 1788. Recorded 24th June 1788, W^m D. Thomas Esq.

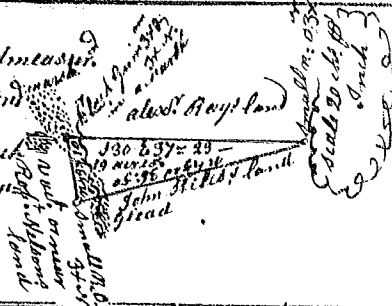

State of S^c Carolina Pursuant to a warrant from John Thomas Esq. Comr. of locations Dated 11th Jan^y 1788, I have admeasured and laid out unto Alexander Gray a tract of 19 acres of land Situate in Greenville County on the S^t Side of the S^t fork of Sugar River, on a small branch of said River, and hath such shape, marks, buttings & boundings as the above Plat represents. Survey 12th Jan^y 1788, W^m D. Thomas Esq. Recorded 23rd June 1788.



S^c Carolina Pursuant to a warrant from John Thomas Esq. Comr. of locations Dated 4th Jan^y 1788, I have admeasured and laid out unto Edward Watson & Michael Walling a tract of six hundred & thirty five acres of land in 96 District, on two small branches of Middle Sugar, and branches of Eliza Thomsons beaver Dam creek of S^t River, in Greenville County, bounded by a line running S 40 E by land survey for J^ohⁿ M^oore N 43 E & S 85 E. by land survey for Michael Walling N 45 E & S 30 E by land survey for Edward Watson S 80 E & John's settlement, N by the S^d Indian boundary, land unknown, N R N^o by James Jordan Esq. all other sides vacant land, and hath such form and marks as the above Plat represents, Survey 5th Jan^y 1788, W^m D. Thomas Esq. Recorded 24th June 1788.



South Carolina Pursuant to a warrant from John Thomas Esq. Comr. of locations Dated 25th March 1788, I have admeasured and laid out unto John Pitts (a soldier) a tract of 200 acres of land (on the bounty) in 96 District, Greenville County, on a branch of Rocky Creek of Rocky River, S. E. by Joseph Needy land S. W. by W^m Needy land, N. W. by land survey for Daniel Rogers bounded, and hath such shape form and marks as the above Plat represents. Certified by Jas^{es} Harrison Esq. Recorded 24th June 1788.

